



## Powerful computing and dynamic scheduling **DEX5350**

The DEX5350 is a **fanless** media player with advanced scheduling possibilities. This high-end computing device supports Ultra HD resolution (4K) playback and its **slim (25 mm)** solid-state design makes the DEX5350 a significant asset to multiple industries including the kiosk market.

The innovative design of the DEX5350 features:

- + Supports 5th generation Intel® Core™ i3-5010U / i5-5350U CPU
- + High performance support for Ultra HD resolution (4K)
- + Watchdog timer
- + Advanced scheduling possibilities due to Super RTC
- + Wake On LAN (WOL)
- + Power recovery via APAR (AC Power Auto Recovery)
- + Raid mode to enhance the reliability of the DEX5350

# DEX5350

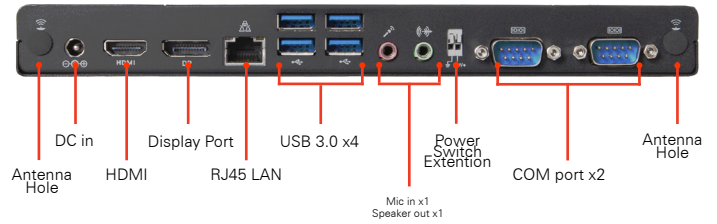
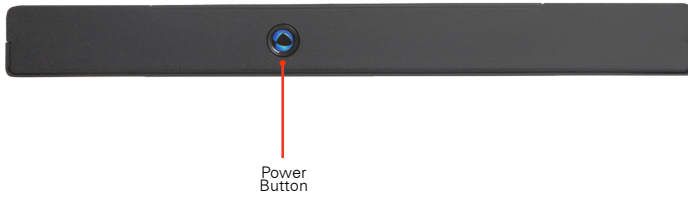

Model name		DEX5350
Feature		Ultra HD (4K) playback combined with advanced scheduling possibilities
Housing Material		SECC/ Aluminum
Chassis Color		Black
Dimension	W x H x D (mm)	240 x 25 x 158 mm
	W x H x D (inch)	9.4 x 0.9 x 6.2 inch
Volume (liters)		0.95 L
CPU	Type	Supports 5th generation Intel® Core™ i3-5010U / i5-5350U CPU
Graphic		Intel® HD 5500 / HD 6000 Graphics up to 1 Ghz
LAN		RJ45 x1 10/100/1000
Memory	Channels	Dual Channel
	Type	DDRIII L SO-DIMM x 2
	DDR	1600Mbps
	Max Memory	16G (based on OS support)
Expansion	M.2	x 1
	Mini-Card (H)	x 1
	Mini-Card(L)	x 1
Storage		M.2 x1 2.5" HDD x1

Rear Panel IO	HDMI 1.4a	x 1
	Display Port	x 1
	Ethernet	x 1
	COM	x 2
	USB 3.0	x 4
	Audio	x 2
	Antenna Hole	x 2
Watchdog Timer		1 sec ~ 255 sec
Power		65W, AC230~110 to DC19V adaptor met DoE VI
Environment		
MTBF		50,000hrs
Operating Temperature		0°C ~45°C (32°F ~ 104°F)
Storage Temperature		-20 ~ 60°C (-4 ~ 140°F)
Relative Humidity		90% RH
Operating Vibration		2 Gms,Random,5~500Hz,X,Y,Z 3 Axes,0.5hr/Axis

Supports:



\*Accessories available on demand



The specifications depicted may be subject to change without prior notice. All trademarks are copyright of their respective owners. © AOPEN Inc.